

# **Arizona Territorial Postmarks**

**1850's to February 14, 1912**

**(Volume 4 — Active Collection)  
Cochise—Original Pima (A to E)—County)**

**By Al Ring**

**This collection was started in the early 1990's and then pretty much stopped in the late 1990's. The collection consisted of the entire state of Arizona. In June of 2006 I started to make new presentation pages and update the collection.**

**The information for the pricing and towns in this collection come from Arizona Territorial Postmark Catalogue originally started by Dr. Sheldon H. Dike then taken over by Owen W. Kriege ph. D and now provided by Jewell L. Meyer. Also used in gathering information is The Postal History Foundation, Will C. Barnes *Arizona Place Names, Arizona Territory Post Offices & Postmasters, & Wells Fargo in Arizona Territory* by John and Lillian Theobald, *Railroads of Arizona Vol. 1*, by David F. Myrick, *Ghosts and Ghost Towns*, by W. J. “Jack” Way, *Ghost Towns and Historical Haunts in Arizona*, by Thelma Heatwole, *Arizona's Best Ghost Towns*, by Philip Varney, and other books where I might get information. Also included many post cards from Al Ring's collection and <http://www.ghosttowns.com/states/az/az.html>.**

# Cochise County

Collection

# Index of Arizona Territorial —Cochise Co.

**Bold** means we have some postmarks from this town. **Underline** means we have one of all that towns postmarks. *Italics* means there are no known postmarks from this town. **Red** means we are actively collecting this town from these counties, Cochise, Pima and Santa Cruz.

<u>Apache</u>	<u>Cochise</u>
Arizmo	Cochise
<i>Aztec</i>	<i>Cochise</i>
<i>Bean</i>	<i>Cochise</i>
Black Diamond	Cochise
Bowie	Cochise
<i>Bannock</i>	<i>Cochise</i>
<u>Chiricahua</u>	<u>Cochise</u>
<b>Cochise</b>	<b>Cochise</b>
<b>Courtland</b>	<b>Cochise</b>
<i>Descanso</i>	<i>Cochise</i>
<b>Don Luis</b>	<b>Cochise</b>
<b>Douglas</b>	<b>Cochise</b>
<b>Dragoon</b>	<b>Cochise</b>
<b>Fairbank</b>	<b>Cochise</b>
Fort Huachuca	Cochise
Galeyville	Cochise
<u>Garces</u>	<u>Cochise</u>
Gatewood	Cochise
<b>Gleeson</b>	<b>Cochise</b>
<i>Glencoe</i>	<i>Cochise</i>
Hamburg	Cochise
<b>Hereford</b>	<b>Cochise</b>
Huachuca	Cochise
Johnson	Cochise
Land	Cochise
<i>Laub</i>	<i>Cochise</i>
Lewis Springs	Cochise
Light	Cochise
<b>Lowell</b>	<b>Cochise</b>
<i>McAlister</i>	<i>Cochise</i>
McNeal	Cochise
Middlemarch	Cochise
<b>Naco</b>	<b>Cochise</b>
<b>Palmerlee</b>	<b>Cochise</b>
Paradise	Cochise
<b>Pearce</b>	<b>Cochise</b>
Pirtleville	Cochise
Pool	Cochise
Portal	Cochise
<i>Powers</i>	<i>Cochise</i>
Reef	Cochise
Rucker	Cochise
Saint David	Cochise
<i>Sample</i>	<i>Cochise</i>
San Bernardino	Cochise
<b>San Simon</b>	<b>Cochise</b>
<i>Servoss</i>	<i>Cochise</i>
<i>Swisshelm</i>	<i>Cochise</i>
<b>Teviston</b>	<b>Cochise</b>
<i>Truitt</i>	<i>Cochise</i>
<b>Turner</b>	<b>Cochise</b>
Turquoise	Cochise
<i>Vota</i>	<i>Cochise</i>
<b>Warren</b>	<b>Cochise</b>
Whitewater	Cochise
Wilgus	Cochise
<b>Willcox</b>	<b>Cochise</b>



# APACHE



**Town**

**Type** Postmark Code Apache – Cochise Co. (1908-1943)

1 4-Bar

**Apache**

**Cochise County**

**Post Route Map, 1929**

On E. P. & S. W. R. R. north of Douglas. "To remember the old days of the Apache raids." A monument erected to commemorate the surrender of Geronimo and his band in 1886 to the military forces was dedicated here April 29, 1934. The surrender was a few miles off in Skeleton canyon. P. O. established May 22, 1908, John W. Richart, P. M.

3

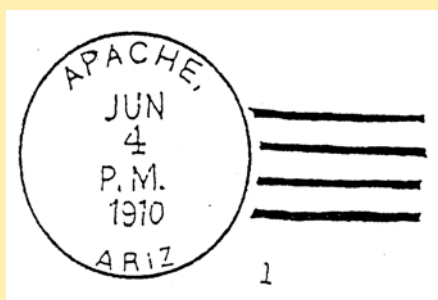

Apache  
Jun 4 1910 Ariz.

Live Stock Sanitary Board, Phoenix, Arizona

Apache Arizona June 2, 1910 Gentlemen I have been referred to you by the county clerk at Kombastous as the board of Live Stock Sanitary Board. having in charge the florng of cattle brands and ear marks I want to get a brand and get some recorded in this county Please advise me the proper steps to take to secure the same and oblige. Yours truly Wm Hunter.



Arizona Territorial Postmarks



# APACHE



## Arizona Territorial Postmarks



DIVISION OF APPOINTMENTS

Location of Proposed Post Office

Post Office Department

OFFICE OF FIRST ASSISTANT POSTMASTER GENERAL

Washington

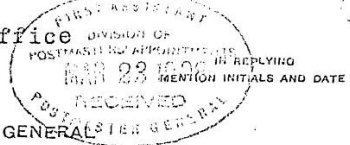

Sir:

With reference to the proposed establishment of a post office at

Apache Lusk, Bochire, ARIZONA  
(Office) (County) (State)

you are requested to supply promptly, on this form, the information and the plot called for, and to cause the proper certificate (page 3) to be correctly filled out.

Respectfully,

C. P. Grandfield  
S. H. Hatcher

Acting First Assistant Postmaster General.

Name, county, and State:

Lusk, Bochire, ARIZONA  
(Name) (County) (State)

Nearest mail route to proposed office (if not on a railroad):

route No. \_\_\_\_\_, from \_\_\_\_\_  
to \_\_\_\_\_; \_\_\_\_\_ times a week.

Nearest railroad: E. P. & S. W.; \_\_\_\_\_; \_\_\_\_\_  
(Name) (Distance in Direct Line) (Direction)

Nearest station: Apache (flag station); 300 ft.; \_\_\_\_\_  
(Name) (Distance by Shortest Road) (Direction)

Nearest post of- Chiricahua; \_\_\_\_\_; \_\_\_\_\_  
fices on same (Name) (Distance by Shortest Road) (Direction)

route: Rodes New Mex.; 12; N. E.  
(Name) (Distance by Shortest Road) (Direction)

Nearest post of- \_\_\_\_\_; \_\_\_\_\_; \_\_\_\_\_  
fice not on (Name)

# APACHE



## Arizona Territorial Postmarks



Location: Township 20-S; range 31-E of the \_\_\_\_\_  
 cipal meridian; section 13; 76th quarter.

I believe the foregoing statements to be correct.

Henrietta Powell Postmaster at Chinicahua J. W. Richmont Proposed Postmaster.  
 (OFFICE NEAREST TO PROPOSED OFFICE)

TOPOGRAPHY, U.S.A.

PLOT SHOWING THE LOCATION OF THE PROPOSED POST OFFICE, WITH THE ADJACENT POST OFFICES, VILLAGES, ROADS, RAILROADS, MAIL ROUTES, RIVERS, AND CREEKS

(NORTH)

RANGE (NO.) (E. OR W.) RANGE 31-E RANGE (NO.) (E. OR W.)

TOWNSHIP (NO.) (N. OR S.) TOWNSHIP 20-S TOWNSHIP (NO.) (N. OR S.)

Scale, one-third inch to the mile.

(SOUTH)

If the locality has not been surveyed by the United States Land Office, a sketch map should be furnished.

6-039

# ARIZMO



Town

Type Postmark Code Arizmo – Cochise Co. (1903-1906)

Doane Ty. 2/1

Arizmo

Cochise County

Colony from Missouri located here. Coined the word from the two abbreviations Ariz. And Mo. P. O. established Sept. 19, 1903, Lewis A. Gregory, P. M.

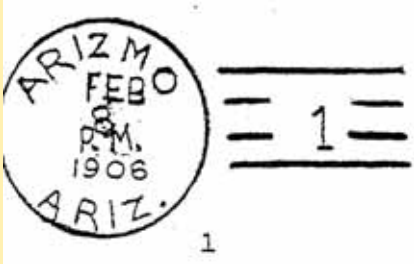

## Post Masters

Lewis A. Gregory	Sept. 19, 1903
Sarah Jewell	May 23, 1904
Discontinued	Sept. 15, 1906
Mail to Douglas	

No. 1011. (LOCATION PAPER.)

Post Office Department,  
OFFICE OF THE FOURTH ASSISTANT POSTMASTER GENERAL,  
DIVISION OF APPOINTMENTS,  
WASHINGTON, D. C., 1906

Sir: Before the Postmaster General decides upon the application for the establishment of a post office at \_\_\_\_\_, County of \_\_\_\_\_, State of \_\_\_\_\_, it will be necessary for you to carefully answer the subjoined questions, get a neighboring postmaster to certify to the correctness of the answers, and return the location paper to the Department, addressed to me.

If the site selected for the proposed office be not on any mail route, only a "Special Office" can be established, to be supplied with mail from some convenient point on the nearest mail route by a special carrier, for which service a sum equal two-thirds the salary of the postmaster will be paid by the Department.

You should inform the contractor, or person performing service for him, of this application, and require him to execute the appended certificate as to the practicability of supplying the proposed office with mail.

Very respectfully,

*J. H. Bristow*  
Fourth Assistant Postmaster General.

To Mr. \_\_\_\_\_  
care of the Postmaster of \_\_\_\_\_, who will please forward to him.

STATEMENT.

The proposed office to be called ARIZMO

Notice directions for selecting post office names on next page.

It will be situated in the \_\_\_\_\_ quarter of Section \_\_\_\_\_ Township 22 S. (North or South), Range 29 E. (East or West), in the County of Cochise, State of Arizona.

It will be on or near route No. \_\_\_\_\_ being the route from \_\_\_\_\_ on which the mail is now carried \_\_\_\_\_ times per week.

Will it be directly on this route?—Ans. \_\_\_\_\_

If not, how much would its supply on this route increase the distance necessarily traveled by the carrier in going once over the route? \_\_\_\_\_

If not on any route and a "Special Office" is wanted, from what office to be supplied? Douglas Ariz.

The name of the nearest office to the proposed one, on one side, is Douglas its distance is 1.7 miles in a Southwest direction from the proposed office.

The name of the nearest office, on the other side, is Buckley Ariz. its distance is 2.0 miles in a Northerly direction from the proposed office.

The name of the other nearest office to the proposed one is Glendale its distance by the most direct road is about 3.0 miles in a Southwest direction from the proposed office.

The name of the most prominent river near it is none

The name of the nearest creek is Silver Creek

The proposed office will be on a bunch of miles from said river, on the west side of it, and will be \_\_\_\_\_ miles from said nearest creek, on the \_\_\_\_\_ side of it.

The name of the nearest railroad is El Paso & Southern R.R.

If on the line of or near a railroad, on which side will the office be

# ARIZMO



## Arizona Territorial Postmarks

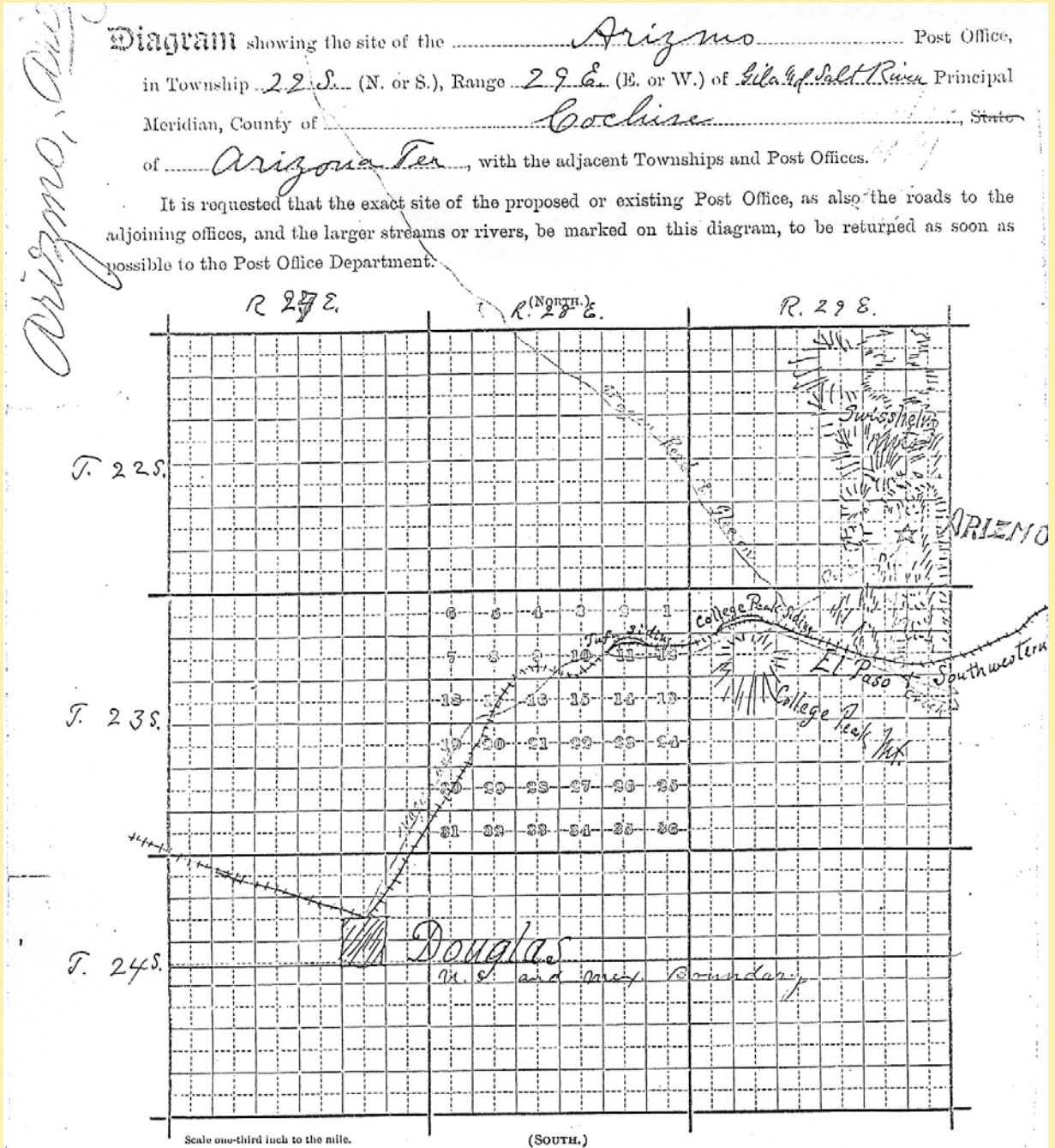

# BLACK DIAMOND



**Town**

**Type** Postmark Code **Black Diamond – Cochise Co. (1902-1908)**

- 1 C1bN1b28
- 2 Doane Ty. 3/2

**Black Diamond**

**Cochise County**

**Map Coronado N. F., 1927.**

In T. 18 S., R. 24 E. “Early day stage station in Dragoon mountains. Named for a mine carrying a black mineral which the miners called “Black Diamond.” Letter of E. G. Mettler, For-est Ranger. P. O. established Feb. 12, 1902, W. H. Schofield, P. M.

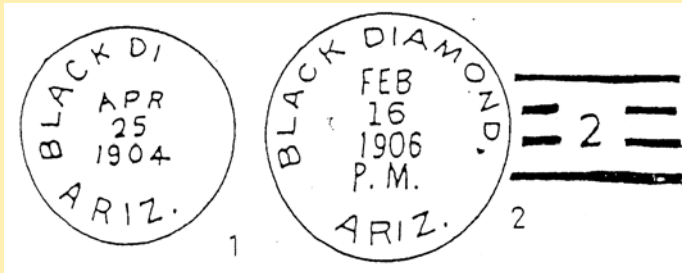

## Post Masters

William H. Schofield  
Lewis M. Kennedy  
Nathaniel E. Hawke  
Edwin I. Kennedy  
Discontinued  
Mail to Pearce

Feb. 12, 1902  
Jan. 13, 1904  
July 26, 1904  
Nov. 22, 1905  
Aug. 31, 1908

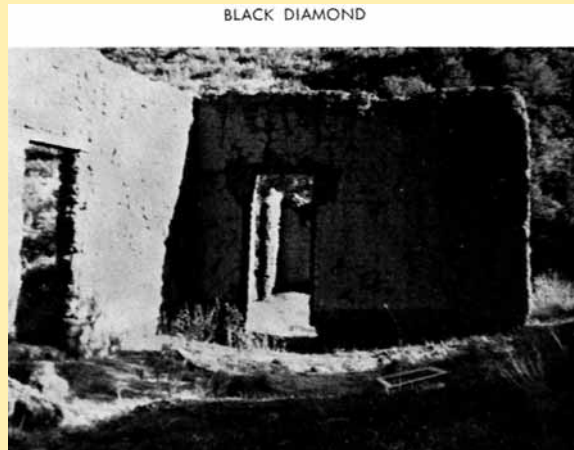

Arizona Territorial Postmarks



# BLACK DIAMOND



## Arizona Territorial Postmarks



\*At a "special office" the postmaster is authorized to employ a carrier to supply the office as often as practicable, for a sum not exceeding two-thirds of the postmaster's compensation.

No. 1011. (LOCATION PAPER.)

Post Office Department,  
OFFICE OF THE FOURTH ASSISTANT POSTMASTER GENERAL,  
APPOINTMENT DIVISION.

WASHINGTON, D. C.,

Sir: Before the Postmaster General decides upon the application for the establishment of a post office at Black Diamond, County of Cochise, State of Arizona, it will be necessary for you to carefully answer the subjoined questions, get a neighboring postmaster to certify to the correctness of the answers, and return the location paper to the Department, addressed to me. If the site selected for the proposed office be not on any mail route, only a "Special Office" can be established, to be supplied with mail from some convenient point on the nearest mail route by a special carrier, for which service a sum equal two-thirds the salary of the postmaster will be paid by the Department.

You should inform the contractor, or person performing service for him, of this application, and require him to execute the appended certificate as to the practicability of supplying the proposed office with mail.

Very respectfully,

*J. H. Bristow*  
Fourth Assistant Postmaster General.

To Mr. *W. H. Schofield*  
care of the Postmaster of *Pearce*, who will please forward to him.

### STATEMENT.

The proposed office to be called

*Black Diamond*

Notice directions for selecting post office names on next page.

It will be situated in the 28 quarter of Section 28, Township 18 (North or South), South Range 24 (East or West), East, in the County of Cochise, State of Arizona.

It will be on or near route No. 63189, being the route from Pearce to Middlemarch, on which the mail is now carried no service times per week.

Will it be directly on this route?—Ans. no

If not, how much would its supply on this route increase the distance necessarily traveled by the carrier in going once over the route? 10 miles

If not on any route, is a "Special Office" wanted?—Ans. yes To be supplied from Pearce

The name

# BLACK DIAMOND



## Arizona Territorial Postmarks



*Black Diamond*

Diagram showing the site of the Black Diamond Post Office,  
in Township 18 South (N. or S.), Range 24 East (E. or W.) of G. & S. R. B. M. Meridian,  
County of Cochise, State of Arizona, with the adjacent Townships and Post Offices.

It is requested that the exact site of the proposed or existing Post Office, as also the roads to the adjoining offices, and the larger streams or rivers, be marked on this diagram, to be returned as soon as possible to the Post Office Department.

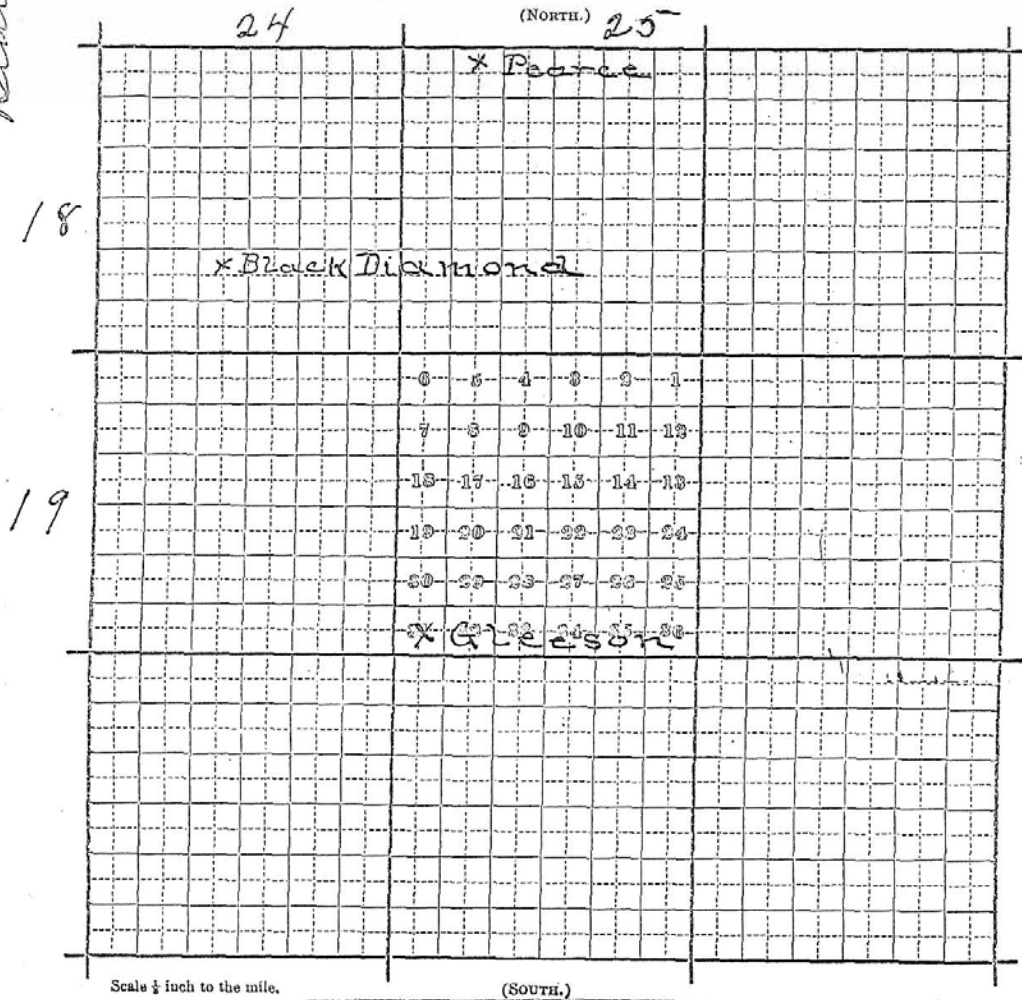

# BOWIE



## Arizona Territorial Postmarks



### Town

**Type** **Postmark Code** Bowie – Cochise Co. (1911-present)

- 1 EX (W. F.)
- 2 4-Bar

### Bowie Cochise County G. L. O. Map, 1892-1921.

In sec 4, T. 13 S., R. 28 E. Station S. P. R. R., at junction

# CHIRICAHUA



**Town**

**Type** Postmark Code Chiricahua – Cochise Co. (1907-1921)

1 4-Bar

**Chiricahua** **Cochise County**

In T. 21 S., R. 21 E. Station E. P. & S. W. R. R., east side Chiricahua range, 3 miles from Douglas. After Chiricahua Indians who once ranged over this region. P. O. established September 14, 1907, Henrietta Powell, P. M.

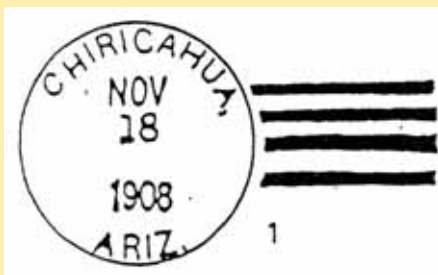

1



Arizona Territorial Postmarks



# CHIRICAHUA



## Arizona Territorial Postmarks



### Post Masters

Henrietta Powell  
Hugh Mack Rodman

Sept. 14, 1907  
July 23, 1908

*Letter*  
Location of Proposed Post Office

DIVISION OF APPOINTMENTS IN REPLYING  
MENTION INITIALS AND DATE

Post Office Department  
OFFICE OF FIRST ASSISTANT POSTMASTER GENERAL  
Washington

M M Mills  
Douglas ARIZONA

Sir: With reference to the proposed establishment of a post office at  
Chiricahua, Cochise, ARIZONA  
(OFFICE) (COUNTY) (STATE)

you are requested to supply promptly, on this form, the information  
and the plot called for, and to cause the proper certificate (page 3)  
to be correctly filled out.

Respectfully,

Chiricahua J. H. Hitchcock  
First Assistant Postmaster General.

Name, county, and State:  
Chiricahua, Cochise, ARIZONA  
(NAME) (COUNTY) (STATE)

Nearest mail route to proposed office (if not on a railroad):  
\_\_\_\_\_ route No. \_\_\_\_\_, from \_\_\_\_\_  
("STAR" OR "RURAL DELIVERY")  
to \_\_\_\_\_; \_\_\_\_\_ times a week.

Nearest railroad: EP & SW RR; \_\_\_\_\_; \_\_\_\_\_  
(NAME) (DISTANCE IN DIRECT LINE) (DIRECTION)

Nearest station: Chiricahua; on R.R.  
(NAME) (DISTANCE BY SHORTEST ROAD) (DIRECTION)

Nearest post of-  
fices on same  
route: Radio NM; 2 1/2 miles N.W.  
(NAME) (DISTANCE BY SHORTEST ROAD) (DIRECTION)

Nearest post of-  
fice not on  
route: Paradise AT; 3 1/2 miles; North  
(NAME) (DISTANCE BY SHORTEST ROAD) (DIRECTION)

Nearest prominent  
river: \_\_\_\_\_; \_\_\_\_\_; \_\_\_\_\_  
(NAME) (DISTANCE IN DIRECT LINE) (DIRECTION)

Nearest creek: San Simon; 6 miles; East  
(NAME) (DISTANCE IN DIRECT LINE) (DIRECTION)

Office from which mail can best be supplied, if proposed office is  
not on a mail route (see page 4): \_\_\_\_\_

Village to be supplied with mail, if any: \_\_\_\_\_  
(NAME)

\_\_\_\_\_; \_\_\_\_\_; \_\_\_\_\_  
(POPULATION) (DISTANCE FROM PROPOSED SITE BY SHORTEST ROAD) (DIRECTION)

Total population to be supplied with mail: 2,03

1011 5-339

# COCHISE



## Arizona Territorial Postmarks



### Town

**Type** **Postmark Code** Cochise – Cochise Co. (1886-1897; 1896-present)

- A C1bN1B28½
- 1 C1bN1B27½
- 2 C1bN1B27½
- 3 M
- 4 C1bN1B28
- 5 C1bN1B28½
- 5A Doane Ty. 1
- 6 Doane Ty. 2
- 7 4-Bar
- 8 St. Line c (A) Scalp

# COCHISE



## Arizona Territorial Postmarks



### Post Masters

Silas H. Gould	Aug. 28, 1886
Discontinued	May 25, 1887
Mail to Dragoon	
Charles R. Sims	Sept. 19, 1896
Thomas Steele	Nov. 28, 1896
John J. Rath	



# Arizona Territorial Postmarks



## COCHISE

No. 1011.

(LOCATION PAPER.)

### Post Office Department,

OFFICE OF THE FOURTH ASSISTANT POSTMASTER GENERAL,  
APPOINTMENT DIVISION,

WASHINGTON, D. C., 1896

Sir: Before the Postmaster General decides upon the application for the establishment of a post office at Cochise, County of Cochise, State of Arizona,

it will be necessary for you to carefully answer the subjoined questions, get a neighboring postmaster to certify to the correctness of the answers, and return the location paper to the Department, addressed to me. If the site selected for the proposed office should not be on any mail route now under contract, only a "Special Office" can be established there, to be supplied with mail from some convenient point on the nearest mail route by a special carrier (see section 702, Postal Laws and Regulations of 1893), for which service a sum equal to two-thirds of the amount of the salary of the postmaster at such office will be paid by the Department.

You should inform the contractor, or person performing service for him, of this application, and require him to execute the inclosed certificate as to the practic

# COCHISE



## Arizona Territorial Postmarks



Diagram showing the site of the Cochise Ariz Post Office,  
in Township ..... (N. or S.), Range ..... (E. or W.) of ..... Principal  
Meridian, County of Cochise State  
of Arizona with the adjacent Townships and Post Offices.

It is requested that the exact site of the proposed or existing Post Office, as also the roads to the adjoining offices, and the larger streams or rivers, be marked on this diagram, to be returned as soon as possible to the Post Office Department.

(North.)

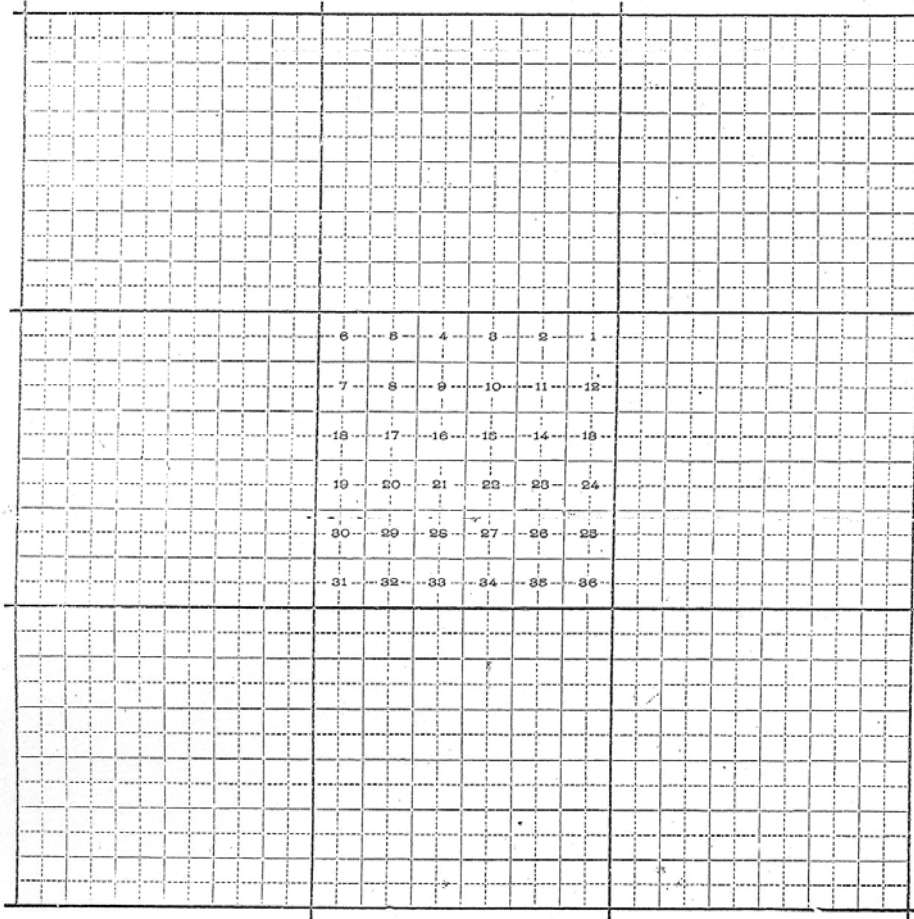

Scale  $\frac{1}{2}$

# COCHISE



## Arizona Territorial Postmarks



### Post Office Department,

TOPOGRAPHER'S OFFICE,

Washington, D. C., March 26<sup>th</sup>, 1903.

Sir:

To enable the Topographer of this Department to determine, with as much accuracy as possible, the relative positions of Post Offices, so that they may be correctly delineated on its maps, the Postmaster General requests you carefully to answer the questions below, and furnish the diagram on the other side, returning the same as soon as possible, verified by your signature and dated, under cover to the Topographer's Office, Post Office Department.

Respectfully, &c.,

*A. von Haake*

Topographer P. O. Dept.

To POSTMASTER AT Cochise

Cochise Co.

Arid  
Cochise

The (P. O. Dept.) name of my Office is \_\_\_\_\_

If the town, village, or site of the Post Office be known by another name than that of the Post Office, state that other name here: Railroad Station Cochise - 2<sup>nd</sup> letter *A initial of O*

# COCHISE



## Arizona Territorial Postmarks



Diagram showing the site of the Cochise Post Office  
in Township 15 So (N. or S.), Range 24 East (E. or W.),  
of 15th Principal Meridian, County of Cochise, State  
of Arizona, with the adjacent Townships and Post Offices.

It is requested that the exact site of your Post Office, as also the roads to the adjoining  
Offices, and the rivers and creeks, be marked on this diagram, to be returned as soon as possi-  
ble to the Topographer's Office, Post Office Department. If on, or near a railroad, mark  
the railroad and adjacent Station accurately.

In localities not surveyed by the U. S. Land Office, a *sketch* map is requested.

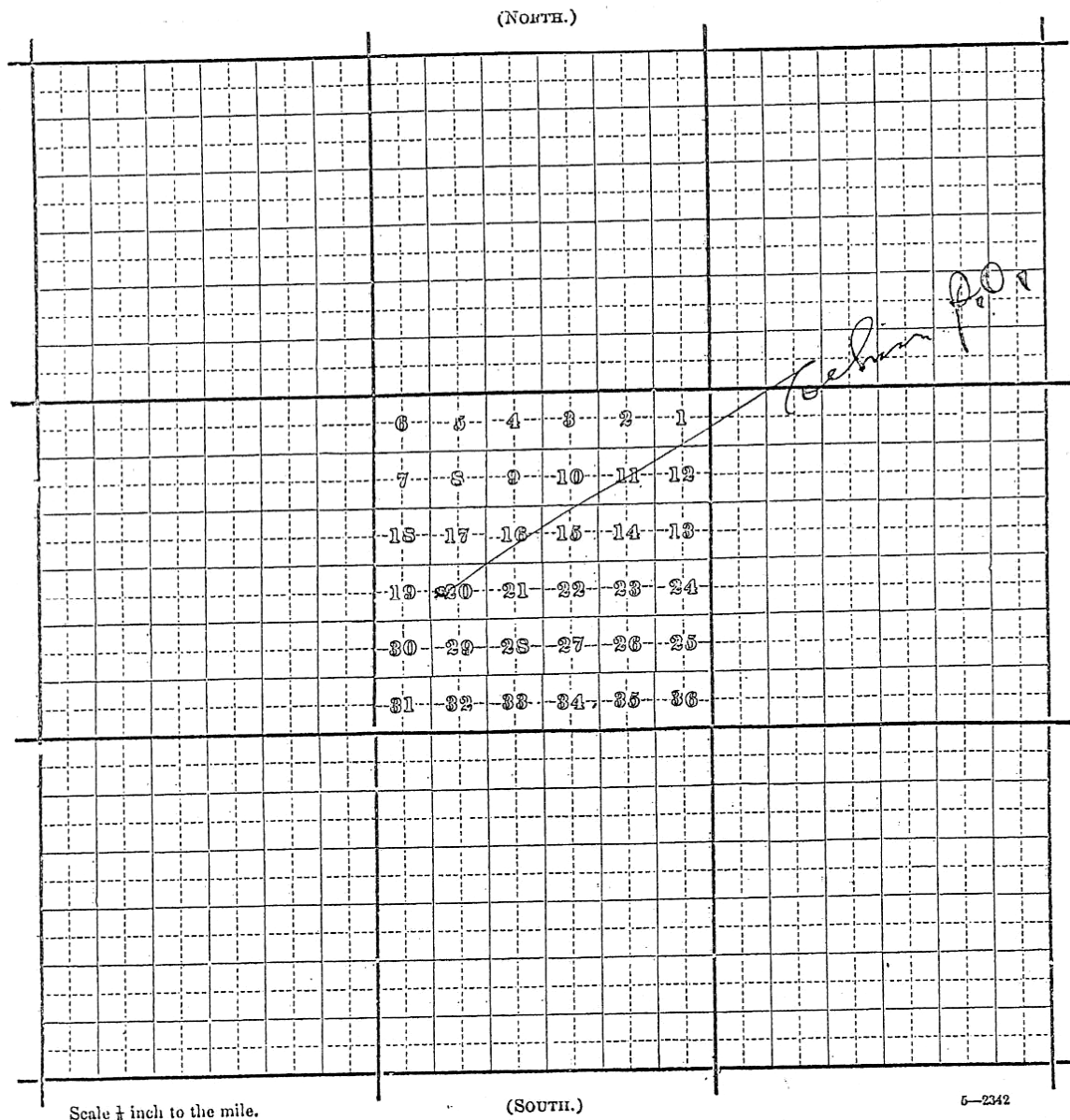



# COURTLAND



## Arizona Territorial Postmarks

**Town**

**Type** **Postmark Code** Courtland – Cochise Co. (1909– 1942)

- A M
- 1 C1bN1B30
- 2 4-Bar
- 3 C1b'16T1b31

**Courtland**

**Cochise County**

**U. S. G. S. Map, 1923.**

In T. 19 S., R. 25 E. Mining camp on short spur Arizona-Eastern R. R. southeast corner Dragoon mountains. After Courtland Young, one of the owners of Great Western Mining Co. which operated several mines here. Town established 1909, by W. J. Young, brother of Courtland Young. P. O. established March 13, 1909, Harry Locke, P.M.



2





# COURTLAND



## Arizona Territorial Postmarks



DIVISION OF TOPOGRAPHY

POST OFFICE DEPARTMENT  
OFFICE OF THE  
FOURTH ASSISTANT POSTMASTER GENERAL  
WASHINGTON



Apr. 17<sup>th</sup> 1909.

Sir:

In order that this office may determine, with as much accuracy as possible, the relative positions of Post Offices, so that they may be correctly delineated on its maps, please carefully answer the questions below, and furnish the diagram on the other side, returning the same as soon as possible, verified by your signature and dated.

Very respectfully,

*C. M. Grant*

Fourth Assistant Postmaster General.



# Arizona Territorial Postmarks



# DON LUIS



## Arizona Territorial Postmarks

### Town

**Type** **Postmark Code** Don Luis – Cochise Co. (1903-1933)

- 1 Done Ty. 2/1
- 2 4-Bar
- 3 4-Bar
- 4 Sl (Reg)

### Don Luis

### Cochise County

### G. L. O. Map, 1921.

Station Bisbee branch E. P. & S. W. R. R. about 6 miles from International Line. Named for Lewis Williams, early Copper Queen superintendent, called "Don Luis" by Mexicans. P. O. established October 7, 1903, John J. Mercers, P.M. He declined to qualify and Mary A. Head was appointed.

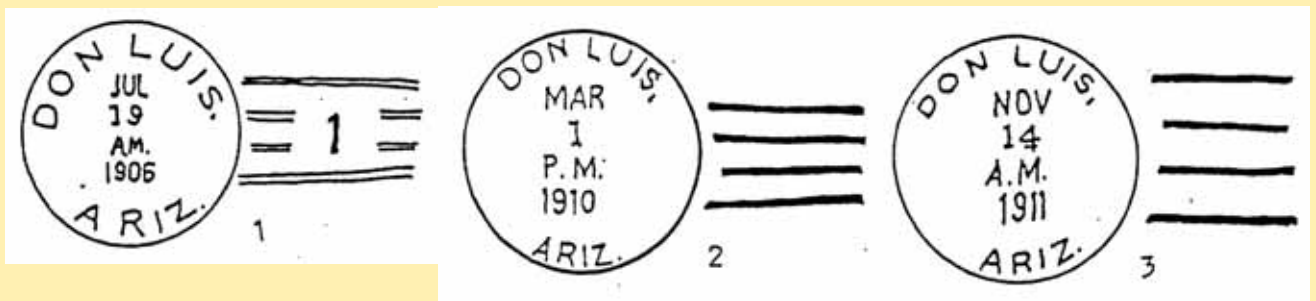

2



# DON LUIS



## Arizona Territorial Postmarks



### Post Masters

John J. Mercers (declined)	Jan. 27, 1903
Mary A. Hull	Oct. 7, 1903
J. H. F. Scholl	1904-1905 W. F.
Abigail Conchin	Sept. 20, 1906
Theodore W. Siek	1906-1909 W. F.
Frederick Hedberg	Dec. 24, 1907
Carlos L. Allen	Aug. 27, 1909
Gardie Bent	May 31, 1910
John F. Wilcox	1910-1911 W. F.
C. F. Barret	1912 W. F.

No. 1011.

(LOCATION PAPER)

**Post Office Department,**  
OFFICE OF THE FOURTH ASSISTANT POSTMASTER GENERAL,  
DIVISION OF APPOINTMENTS.

WASHINGTON, D. C.,

SIR: Before the Postmaster General decides upon the application for the establishment of a post office at \_\_\_\_\_, County of \_\_\_\_\_, it will be necessary for you to carefully answer the subjoined questions, get a neighboring postmaster to certify to the correctness of the answers, and return the location paper to the Department, addressed to me.

If the site selected for the proposed office be not on any mail route, only a "Special Office" can be established, to be supplied with mail from some convenient point on the nearest mail route by a special carrier, for which service a sum equal two-thirds the

# DON LUIS



## Arizona Territorial Postmarks



*Answer at once!*

### Post Office Department,

TOPOGRAPHER'S OFFICE,

Topographer P. O. Dept.  
APR 1 1904

*Washington, D. C., March 5, 1904.*

Sir:

To enable the Topographer of this Department to determine, with as much accuracy as possible, the relative positions of Post Offices, so that they may be correctly delineated on its maps, the Postmaster General requests you carefully to answer the questions below, and furnish the diagram on the other side, returning the same as soon as possible, verified by your signature and dated, under cover to the Topographer's Office, Post Office Department.

Respectfully, &c.,

Topographer P. O. Dept.

To POSTMASTER AT Don Luis,  
Cochise Co.,  
Arizona.

The (P. O. Dept.) name of my Office is Don Luis

# DON LUIS



## Arizona Territorial Postmarks

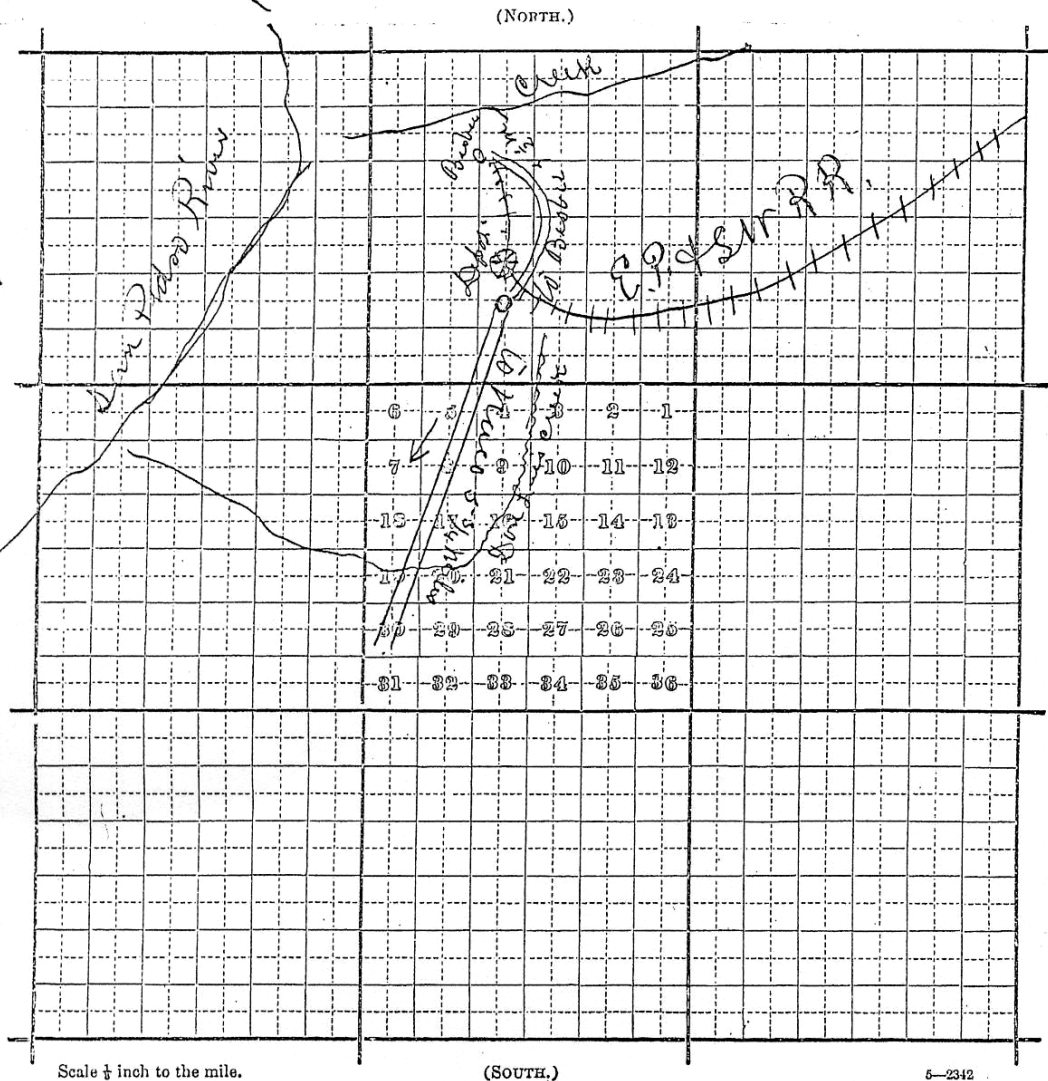

Diagram showing the site of the Don Luis ~~Post~~ Post Office  
in Township 23 (~~E~~ or S.), Range 24 (E. or ~~W~~),  
The Gila ~~and Salt~~ River Principal Meridian, County of Pachise, State  
of Arizona, with the adjacent Townships and Post Offices.

It is requested that the exact site of your Post Office, as also the roads to the adjoining Offices, and the rivers and creeks, be marked on this diagram, to be returned as soon as possible to the Topographer's Office, Post Office Department. If on, or near a railroad, mark the railroad and adjacent Station accurately.

In localities not surveyed by the U. S. Land Office, a *sketch* map is requested.

Note  
Will : Township and Range  
be surveyed about 1870



# DON LUIS



## Arizona Territorial Postmarks



### POST OFFICE DEPARTMENT

OFFICE OF THE

FOURTH ASSISTANT POSTMASTER GENERAL

WASHINGTON

DIVISION OF TOPOGRAPHY

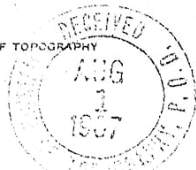

July 9 - 1907

Sir:

In order that this office may determine, with as much accuracy as possible, the relative positions of Post Offices, so that they may be correctly delineated on its maps, please carefully answer the questions below, and furnish the diagram on the other side, returning the same as soon as possible, verified by your signature and dated.

Very respectfully,

*[Signature]*

Fourth Assistant Postmaster General.

To POSTMASTER AT Don Luis

Cochise Co.

Ariz

The (P. O. Dept.) name of my Office is Don Luis, Arizona

If the town, village, or site of the Post Office be known by another name than that of the Post Office, state that other name here: Hedberg Addition

The P. O. is situated in the South-west quarter of Section No. 28, in Township Hedberg (or south), Range of Don Luis (east or west), County of Cochise, State of Territory of Arizona

The name of the most prominent river near it is San Pedro river

The name of the nearest creek is No Creek

This Office is 15 miles from said river, on the east side of it, and is X miles from said nearest creek, on the X side of it.

My Office is on Mail Route No. 268037

# DOUGLAS



## Town

## DOUGLAS



## Arizona Territorial Postmarks



No. 1011.

(LOCATION PAPER.)

Post Office Department,  
OFFICE OF THE FOURTH ASSISTANT POSTMASTER GENERAL,  
APPOINTMENT DIVISION.

WASHINGTON, D. C., \_\_\_\_\_, 190

SIR: Before the Postmaster General decides upon the application for the establishment of a post office at Douglas, County of Cochise, State of Arizona, it will be necessary for you to carefully answer the subjoined questions, got a neighboring postmaster to certify to the correctness of the answers, and return the location paper to the Department, addressed to me. If the site selected for the proposed office be not on any mail route, only a "Special Office" can be established, to be supplied with mail from some convenient point on the nearest mail route by a special carrier, for which service a sum equal two-thirds the salary of the postmaster will be paid by the Department.

You should inform the contractor, or person performing service for him, of this application, and require him to execute the appended certificate

# DOUGLAS



## Arizona Territorial Postmarks

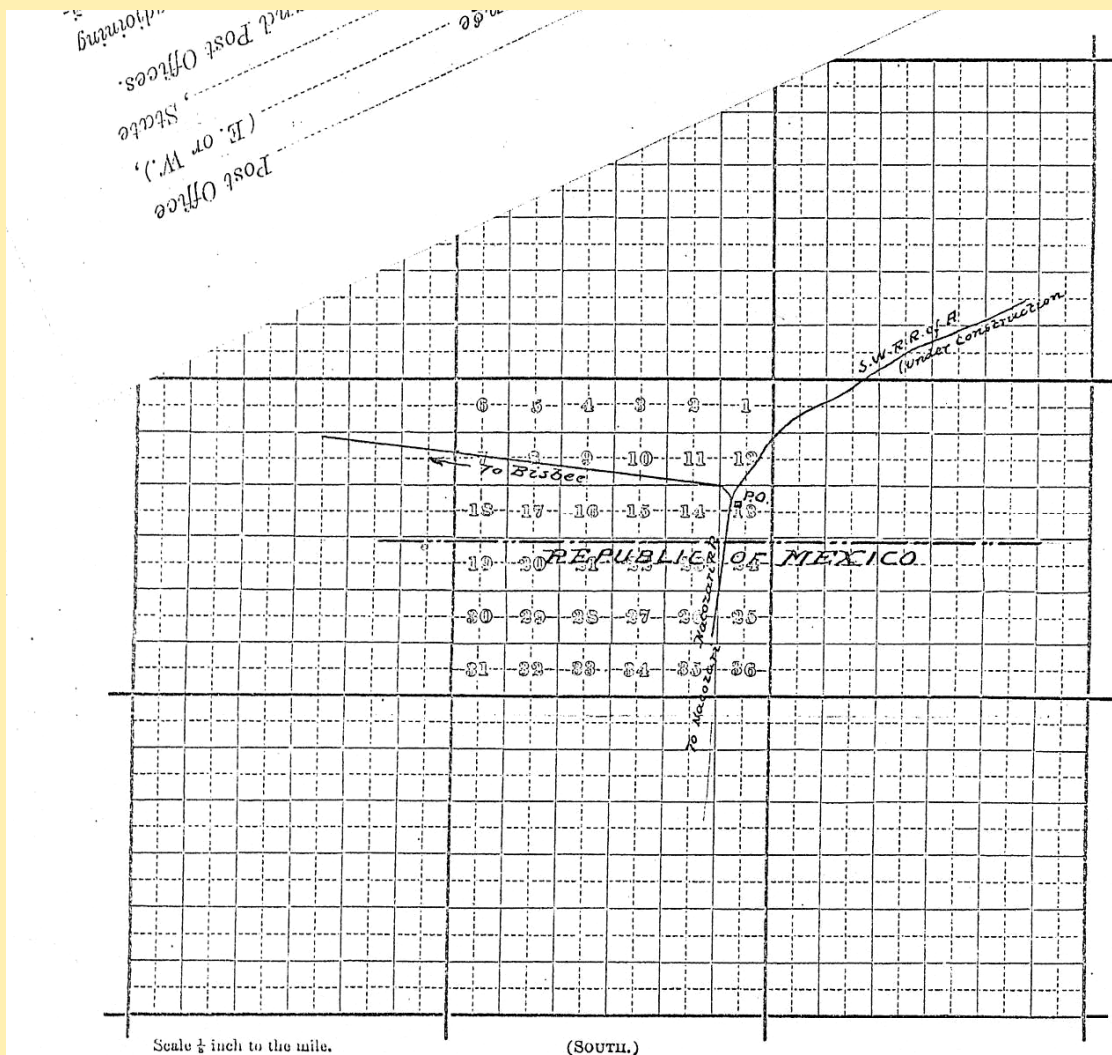

### INSTRUCTIONS RELATIVE TO NAMES OF POST OFFICES.

Attention is called to the following order issued by the Postmaster General, dated April 9, 1894:

"ORDERED, No. 114.—

# DOUGLAS

2



## Arizona Territorial Postmarks







# DRAGOON



# DRAGOON



## Arizona Territorial Postmarks

### Post Masters

Cassius M. Hooker	June 20, 1881
Woodson A. Langhorne	March 24, 1882
Frank E. Callisch	1883 W. F.
Frank E. Callisch	June 27, 1883
Woodson A. Langhorne	1884-1885 W. F.
Discontinued	Sept. 18, 1884
Mail to Willcox	
William Fourr	Nov. 14, 1884
D. C. Haskin	1886-1887 W. F.
Edgar S. Barnes	1888 W. F.
T. R. Abernethy	1889-1903 W. F.
H. D. Morey	1904-1905 W. F.
Walter Earl Moore	1906-1907 W. F.
J. H. Innes	1908 W. F.
Ralph Edward Cushman	1908-1909 W. F.
Ralph E. Cushman	July 28, 1909
Willie John Stender	1909-1910 W. F.
J. C. O'Connor	1911-1912 W. F.



# FAIRBANK



## Town

### Type Postmark Code

Fairbank – Cochise Co. (1883-1981)

- 1 C41eN1B29½
- 2 C1aN1RRB26
- 3 C1bN1BBR26
- 4 EX (W. F.)
- 5 C1dS1B32
- 6 C1bN1B26½
- 7 C1bT1B27
- 8 C1bN1B27
- 9 C1bN1B27
- 10 C1bT1B29
- 11 4-Bar

## Fairbank

## Cochise County

## G. L. O. Map, 1921.

In T. 20 S., R. 21 E. Station on San Pedro river, established in 1882 on e. P. & S. W. R. R. at junction Tombstone branch. Named for N. K. Fairbank, well-known Chicago merchant who was interested in mines around Tombstone, 1882. P. O. established May 13, 1883, John Dessart, P.M.

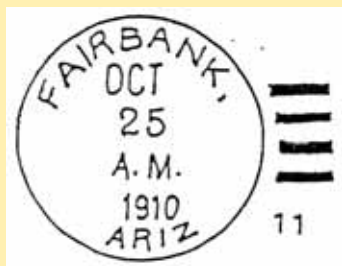

# FARIBANK



# FARIBANK



## Arizona Territorial Postmarks



Diagram showing the site of the \_\_\_\_\_ Post Office  
in Township \_\_\_\_\_ (N. or S.), Range \_\_\_\_\_ (E. or W.),  
of \_\_\_\_\_ Principal Meridian, County of \_\_\_\_\_, State  
of \_\_\_\_\_, with the adjacent Townships and Post Offices.

It is requested that the exact site of your Post Office, as also the roads to the adjoining  
Offices, and the rivers and creeks, be marked on this diagram, to be returned as soon as poss







# Arizona Territorial Postmarks



## FARIBANK

11

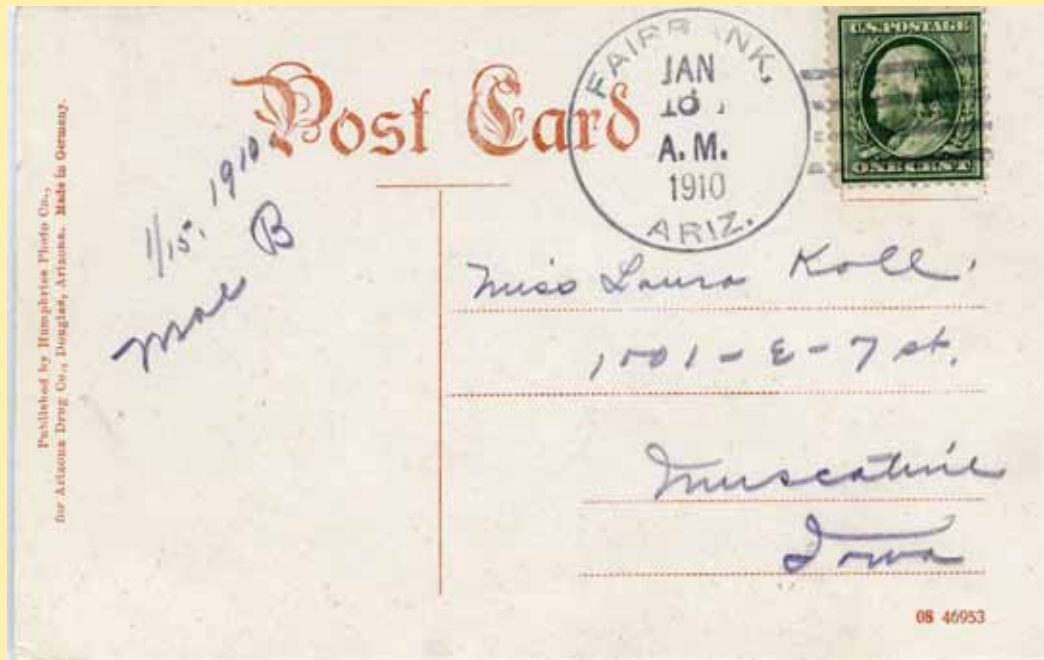

# FORT HUACHUCA



## Arizona Territorial Post-

### Town

### Type Postmark Code

Fort Huachuca – Cochise Co.

(1891-1974)

- 1 C41eN1B32
- 2 Type 2 is Camp Huachuca T-1
- 3 C1bS1bBB31½
- 4 C1b15S1bBB32
- 5 SL (REG)
- 6 C1bT1B28
- 7 C41eN1B28½
- 8 C1bT1B28
- 9 C1bT1B29
- 10 C1bT1B30
- 11 4-Bar
- 12 C31b'17N1B28
- 13 C1b'16T1B29

# FORT HUACHUCA



## Arizona Territorial Postmarks



(No. 1071.)

### Post Office Department,

OFFICE OF THE FIRST ASSISTANT P. M. GENERAL,

WASHINGTON, D. C., 187



# FORT HUACHUCA



## Arizona Territorial Postmarks



(101.)

Post Office Department,  
TOPOGRAPHER'S OFFICE,  
Washington, D. C. *Apr 28<sup>th</sup> 1891*

Sir:

To enable the Topographer of this Department to determine, with as much accuracy as possible, the relative positions of Post Offices, so that they may be correctly delineated on its maps, the Postmaster General requests you to fill up the spaces below, and the diagram on fourth page, returning the same, verified by your signature and dated, under cover to this Office.

Respectfully, &c.,

*C. Raiser*  
Topographer P. O. Dept.

To POSTMASTER AT *Fort Huachuca - Lata Cienega Grande*  
*Cochise Co*  
*Arizona*

The (P. O. Dept.) name of my Office is *Fort Huachuca Lata Cienega Grande*  
\*Its local name is *Fort Huachuca*  
It is situated in the *Military Reservation* quarter of Section No. \_\_\_\_\_

# FORT HUACHUCA



## Arizona Territorial Postmarks



Diagram showing the site of the \_\_\_\_\_ Post Office  
in Township \_\_\_\_\_, Range \_\_\_\_\_ of \_\_\_\_\_ Principal  
Meridian, County of \_\_\_\_\_, State  
of \_\_\_\_\_, with the adjacent Townships and Post  
Offices.

It is requested that the exact site of the proposed, or existing Post Office, as also the  
roads to the adjoining

# FORT HUACHUCA



## Arizona Territorial Postmarks



PLEASE FILL UP THIS BLANK AND RETURN IT TO THIS OFFICE.

Office, Fort Huachuca  
County, Cochise  
State, Arizona



The proposed site is distant four miles from the present location of the office, and will be in a N.E. by North direction from the present site, and directly on route No. 28705

5-1865

# FORT HUACHUCA



## Arizona Territorial Postmarks

### Post Office Department,

TOPOGRAPHER'S OFFICE,

Washington, D. C., March 26<sup>th</sup>, 1903.

Sir:

To enable the Topographer of this Department to determine, with as much accuracy as possible, the relative positions of Post Offices, so that they may be correctly delineated on its maps, the Postmaster General requests you carefully to answer the questions below, and furnish the diagram on the other side, returning the same as soon as possible, verified by your signature and dated, under cover to the Topographer's Office, Post Office Department.

Respectfully, &c.,

# FORT HUACHUCA



## Arizona Territorial Postmarks



Diagram showing the site of the Fort Huachuca Post Office  
in Township \_\_\_\_\_ (N. or S.), Range \_\_\_\_\_ (E. or W.),  
of \_\_\_\_\_ Principal Meridian, County of Cochise, <sup>Territory</sup> State  
of Arizona, with the adjacent Townships and Post Offices.

# FORT HUACHUCA

3



## Arizona Territorial Postmarks

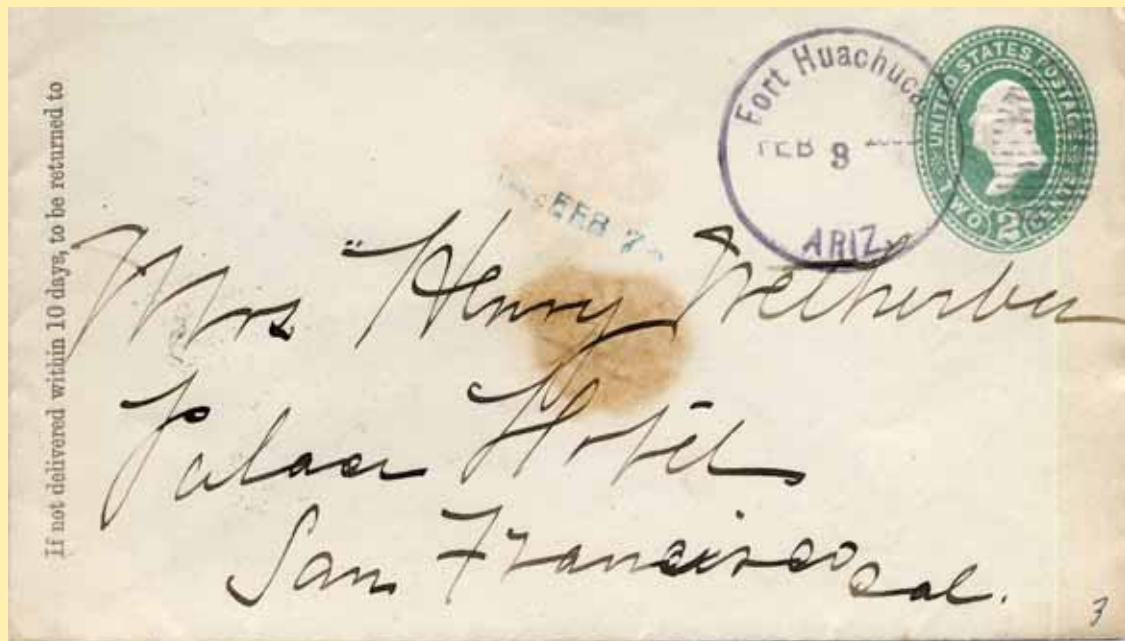

# GALEYVILLE



## Arizona Territorial Postmarks



**Town**

**Type** Postmark Code **Galeyville Cochise Co. (1881-1882)**

1 C21cN1B29

**Galeyville**

**Cochise Co.**

**Hamilton Map, 1886; Judge, 1916.**

In T. 31 E., R. 17 S. Coronado N. F. Named for John H. Galey Pennsylvania oil man, president of the Texas Consolidated Mining and Smelting Co. Near Paradise camp in Chiricahua mountains.

"Galeyville, Curley Bill's last capital, sprang up in the fall of 1880 as a boom silver camp on Turkey creek canyon, on the east side of Chiricahua's. Named for John H. Galey who owned the Discovery mine and established a small smelter there. Town totally deserted by 1882. Never had more than 300 or 400 people. *Tombstone*.

*Arizona Gazetteer*, 1881, says: "A weekly paper, the *Galeyville Bulletin*, is published here. Place occupies a picturesque site in the midst of shady oaks, in a cool corner of Chiricahua's. P. O. established January 6, 1881, Frank McCandless, P. M.



### Post Masters

Frank McCandless  
Discontinued  
Mail to Willcox

Jan 6, 1881  
May 31, 1882



# GATWOOD



## Arizona Territorial Postmarks



### Town

**Type** **Postmark Code** **Gatwood** **Cochise Co.** **(1890-1894)**

1 C1bN1BBR28½

### Gatewood

### Cochise Co.

### G. L. O. Map, 1892.

Town in San Simon valley about twelve miles northeast of old Camp Bowie. Named for Lieut. Charles B. Gatewood, 6th U. S. Cavalry, who from 1878 to about 1887, was constantly in the field after hostile Apaches. He was an early commander of Apache Indian scouts. The author knew him well. A tall, serious, grave-faced man, who spoke at least two Apache dialects fluently and had full confidence of the Indians. Conducted preliminary negotiations which eventually led to Geronimo's surrender. But for Gatewood's bravery and the confidence the Indians had in him and his faith in them, Geronimo might never have surrendered. Gatewood had a long, prominent nose, so the Apaches always called him "Bay-chin-day-sin" (Long Nose). P. O. established June 7, 1890, Joseph M. Hooker, P. M.

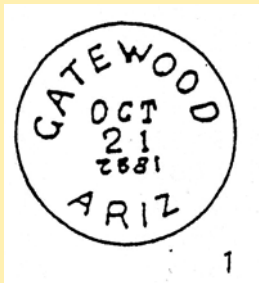







# Arizona Territorial Postmarks



## GLEESON

NO. 1911.

### Post Office Department, OFFICE OF THE FOURTH ASSISTANT POSTMASTER GENERAL, APPOINTMENT DIVISION.

WASHINGTON, D. C., JUN 19 1906, 190



# GLEESON



## Arizona Territorial Postmarks



No. 1019, NEW SERIES.

### Post Office Department,

OFFICE OF THE FOURTH ASSISTANT P. M. GENERAL,  
APPOINTMENT DIVISION,

Washington, D. C., APR 22 1902, 190

SIR:

Before the Postmaster General decides upon the application for a change of site of the post office at Gleeson, County of Cochise, State of Arizona, to \_\_\_\_\_ he

# GLEESON



## Arizona Territorial Postmarks



### Post Office Department,

TOPOGRAPHER'S OFFICE,

Washington, D. C., May 28, 1902

Sir:

To enable the Topographer of this Department to determine, with as much accuracy as possible, the relative positions of Post Offices, so that they may be correctly delineated on its maps, the Postmaster General requests you carefully to answer the questions below, and furnish the diagram on the other side, returning the same as soon as possible, verified by your signature and dated, under cover to the Topographer's Office, Post Office Department.

Respectfully, &c.,

Give new site  
600 rds. N.W.

*A. W. H. H. H.*  
Topographer P. O. Dept.

To POSTMASTER, AT

*Gleeson*  
*Cochise Co.*  
*Arizona*

The (P. O. Dept.) name of

# GLEESON



## Arizona Territorial Postmarks

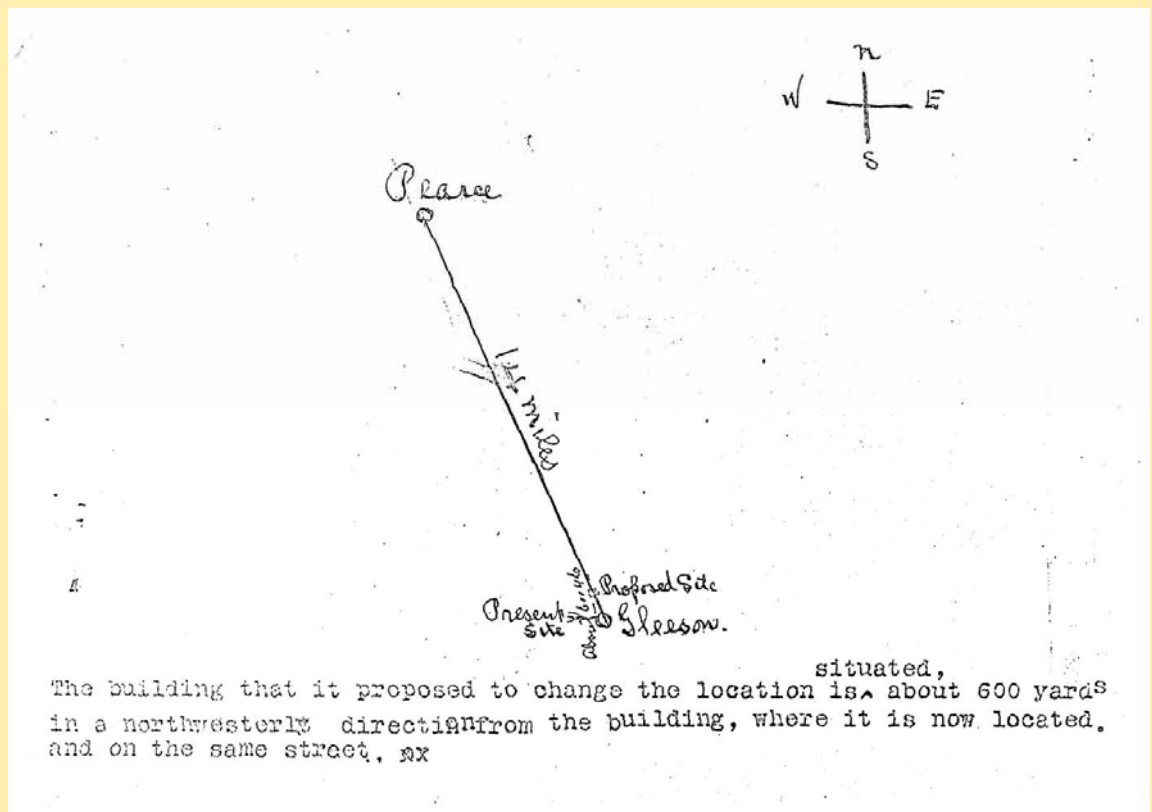
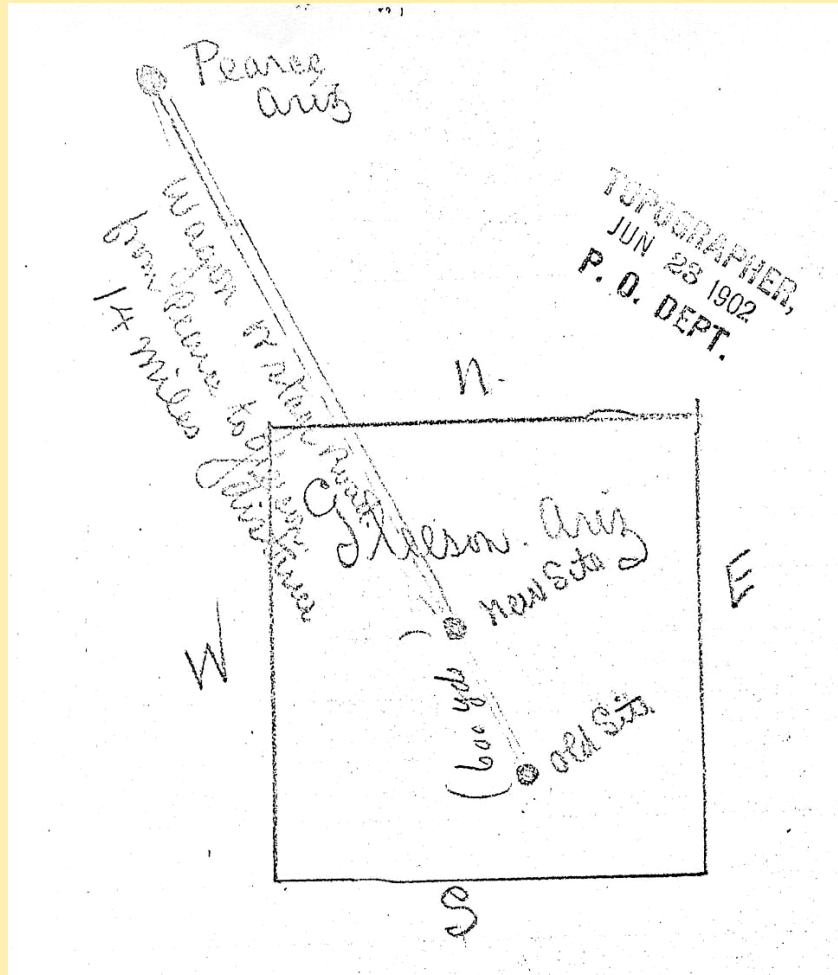



HAMBURG

Town  
Type Postmark Code **Hamburg Cochise Co. (1906-1916; 1925-1929))**  
Post Masters  
1 4-Bar Louise deVere Hamburg Oct. 5, 1906

**Hamburg Cochise Co. G. L. O. Map, 1921.**  
In sec. 9, T. 23 S., R. 20 E. Coronado N. F. Settlement and peak on Ramsay canyon, Huachuca mountains. South of Huachuca Military Reservation.  
“Many years ago an old German, Henry Hamburg, had a mine here called the Hamburg mine. Locally the mines were called “Stromberg and Hamburg” group of copper mines.” Letter, P. M., Sunnyside. P. O. established October 5, 1906, Louise de vera Hamburg, P. M.

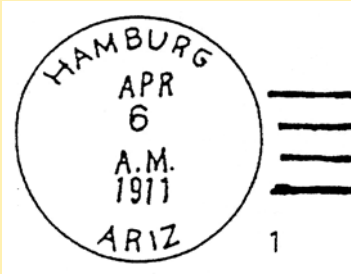



# Arizona Territorial Postmarks



## HAMBURG

No. 1011. (LOCATION PAPER.)

**Post Office Department,**  
OFFICE OF THE FOURTH





# HEREFORD



## Arizona Territorial Postmarks



### Post Masters





# HUACHUCA



**Town**

**Type** Postmark Code **Huachuca Cochise Co. (1881-1882) Was Camp Huachuca officially)**

1 C21bN1RRB27½

**Huachuca**

**Cochise Co.**

**G. L. O. Map, 1923.**

Military post 12 miles from Mexican line, at northern end of Huachuca mountains. "First occupied y U. S. Troops March 3, 1877." Heitman List. Gen. Leonard Wood came to this post in 1877, a young army surgeon, his first station. P. O. established as Camp Huachuca November 21, 1879, Fred L. Austin P. M.

## Post Masters (I think Fort Huachuca

Joseph Fish	1881-1883 W. F.
J. A. Field	1883 W. F.
Milton T. Webb	1884-1887 W. F.
George A. Griffin	1888-1889 W. F.
O. F. Reubendale	1890-1891 W. F.
George E. Sullivan	1892-1895 W. F.
Seymour Horatio Fine	1896 W. F.
J. E. DeRosear	1896-1898 W. F.
A. B. McGaffey	1898-1900 W. F.
Harvey Louis Rhodes	1900-1901 W. F.
Carl Hoyt Brown	1901-1904 W. F.
W. H. Daum	1904-1905 W. F.
George Horace Keyes	1905-1906 W. F.
Charles Hanson Brownell	1907 W. F.
O. H. John	1908 W. F.
Charles Hanson Brownell	1908-1909 W. F.
O. H. John	1910-1911 W. F.
William John Hookway	1912 W. F.

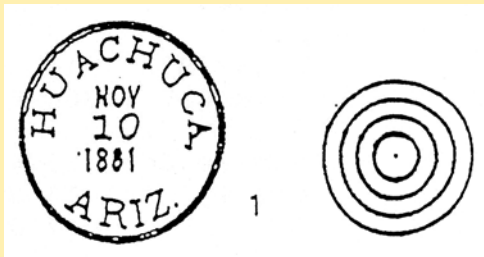

Arizona Territorial Postmarks



# JOHNSON



## Town

**Type** **Postmark Code** Johnson Cochise Co. (1895-1909)

- 1 C1bN1B27½
- 2 Doane Ty. 2/2
- 3 4-Bar

## Johnson

## Cochise Co.

## U. S. G. S. Map, 1923.

Station and mining camp, on Dragoon branch railroad, east side of Little Dragoon mountains. In T. 15 S., R. 22 E. P. O. established April 5, 1900, William De H. Washington, P. M.

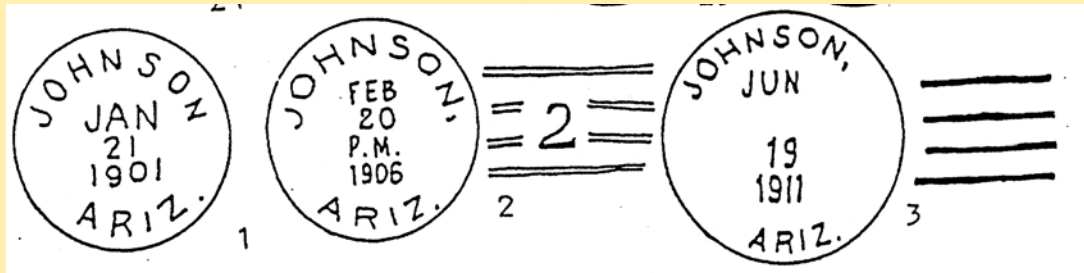

## Post Masters

William deH Washington	April 5,
------------------------	----------





# LAND



## Arizona Territorial Postmarks



Town

Type Postmark Code Land Cochise Co. (1911-1





































































































































































































































































































